

Developing Win-Win Partnerships through Knowledge and New Products

Volume 81 • August 2010

## Product News

### This Winter, the Forecast Calls for Fasco!

"Very cold and snowy. Bitterly cold and dry. Colder and wetter than normal." Those are just some of the chilling long-range forecasts for winter this year in much of the United States from the *Farmers' Almanac*. But if there's one thing you can count on (and long range weather forecasts may not be one of them!), it's that Fasco will have all the heating season products you'll need to help people stay warm this winter.

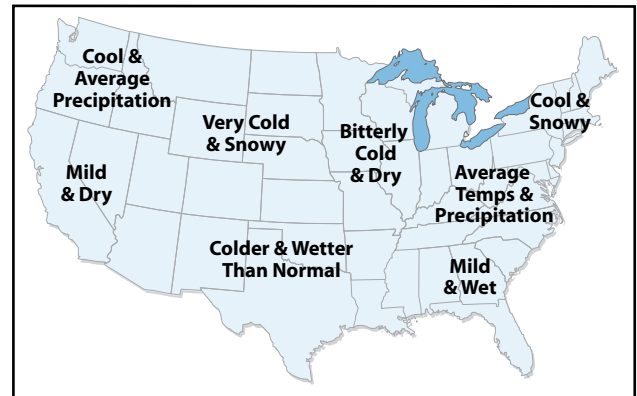

*Farmers' Almanac Winter Outlook for 2010*

### Fasco Still Leads the Industry in Direct Replacement Draft Inducers



For many years, Fasco has led the industry in direct replacement draft inducers, thanks to our wide selection of products from which to choose. Goodman, ICP, Lennox, Nordyne, Rheem, Trane...you'll find Fasco has just the right direct replacement for every major brand, which is critically important to insist upon using to maintain the safety and efficiency of the furnace.

In fact, to help your counter people recommend the right direct replacement draft inducer, you should also take the time now to make sure you have plenty of copies of our free *Fasco Draft Inducer Cross Reference Guide*. This handy booklet includes our wide range of direct replacement furnace draft inducers, as well as our line of direct replacement water heater draft inducers, all listed by OEM. It's the fast and easy way to find the exact Fasco replacement your customers need.

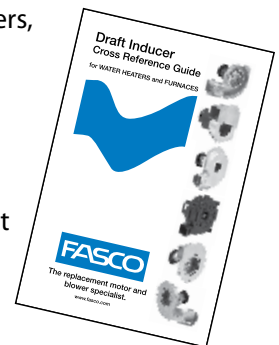

*Fasco's Draft Inducer Cross Reference Guide*

### Fasco Also Leads the Way in Alternative Home Heating Direct Replacements

From combustion air blowers and auger motors for pellet stoves, to centrifugal and Transflo® blowers and blower wheels for gas or wood-burning fireplace applications, Fasco has every direct replacement item your customers will need for repairing alternative sources of home heating. That's because Fasco still remains the leading OEM supplier of blowers and motors for fireplace and stove manufacturers, offering the widest selection of direct replacements available for most major brands.

And here's another great way you can make sure your customers get the parts they need: keep copies of our free fireplace and stove *Heating Season Reference Guide* on hand. This 8-page guide alphabetically lists our replacements for more than 50 manufacturers of fireplaces and stoves, both gas and solid fuel.

For more information on any of the heating season products we've mentioned here, contact your Fasco Sales Representative. And to order your free copies of the handy heating season reference guides we've mentioned above, just call our Customer Service Department at 1-800-325-8313.

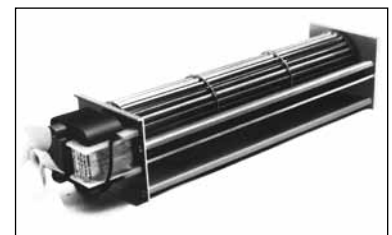

*B22507 Transflo® Blower*

## New Product News

### Fasco Introduces New Four Prong Fas Mount Flexible Mounting Bracket

Fasco is pleased to introduce an addition to our Fas Mount series of bracket kits – the new four prong FM554 Fas Mount Bracket Kit.

Similar to the FM55 Fas Mount Bracket Kit that has three mounting legs, the new FM554 was designed to accommodate residential HVAC direct drive blower applications requiring a four-legged configuration, which more and more OEMs are including in their products.

The new FM554 is for 9" and 10" bolt circle diameters only, with mounting legs evenly spaced at 90° angles. Each FM554 kit includes a four-wing flex mount bracket, mounting hardware (including grommets and eyelets), plus an installation sheet.



*The new FM554 four prong Fas Mount Bracket Kit.*

## Tech Tips

### Motor Mounting Made Easy

Motor replacements differ from job to job. Some are simple and some can have a few challenges. But having the right parts – and the right information – can make any job easier. So in addition to keeping Fasco accessories in stock, you can also pass on these helpful tips to your customers:

- If the motor to be replaced is mounted in a resilient base, the distance between the mounting rings must match within 1/4". Rubber mounting rings are 2-1/4" or 2-1/2" in diameter. Turning the rings around on the motor hubs will change the distance between the mounting points on the rings by 1/4".
- The distance from the bottom of the base to the centerline of the shaft must be matched. This dimension is usually 3" or 3-1/2". Fasco offers different sizes of cradle bases to fit most of the cradle mounted models.
- In many direct drive blower applications, the motor is mounted partially within the blower housing with a three point lug mount. Direct OEM replacement motors would come with lugs already welded on the

motor. For general replacement, Fasco lug kits are available with a variety of mounting hole bolt circle diameters. Use of these kits provide what is commonly called a "belly band" mounting.

- A mounting method which has become very popular in recent years is the flexible mounting brackets which Fasco calls the "Fas Mount." Three or four specially designed steel mounting arms are welded to a sturdy belly band. The shape of the arms provide superior vibration and noise isolation.

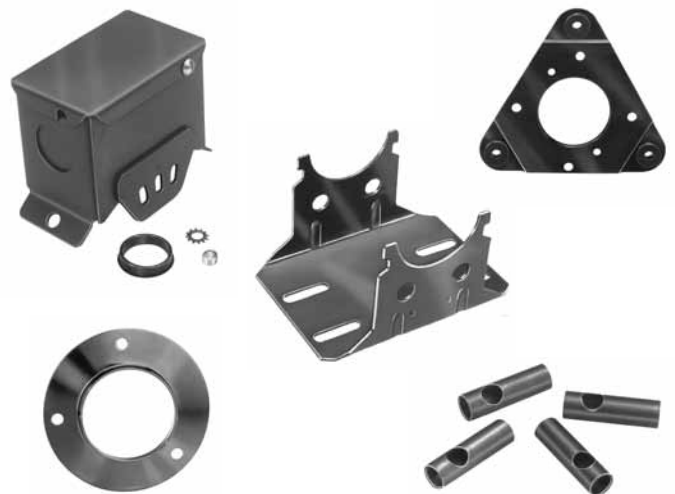

## Marketing News

### Please Stay "Tuned" for More on the New Fasco Rewards Program

More last minute delays have unfortunately kept us from completing all the final details of our new Fasco Rewards Program this month. As we've mentioned before, however, we appreciate your patience during this process of getting the new program launched.

 Printed on recycled paper.